

CONGRESS NAME	ICNC 2019, Lisboa	
Room Name	Lisboa - LR1 - Auditorium 2	
Capacity	300 seats arranged in theatre style	
Stage Size	W: 1100 / D: 200 / H: 20 cm	
For Chairpersons	Table Dimensions	4x (W x D x H : 80 x 60 x 71cm)
	Standard setup	2 Tables + 4 chairs
	Microphones	2 wired Goose Neck
	Video Monitor	40" on chairperson table x 1
	Camera	NO
For Speaker	Lectern Dimensions	W: 66 / D: 60 / H: 110 cm
	Microphones	2 Wired Goose Neck
	Computer	1 classic laptop Cyim networked with SSC
	Camera	NO
Main Screen	508 x 294	
Projector	12K - 1920*1080	
PinP	NO	
Voting / Ask a question system	NO	
Live sessions enabled	NO	
Audience	4 HAND HELD WIRELESS	
External monitor for room programme and overflow	NO	

Lecture Room plan

- Screen
- Room entrance(s)
- Microphone Q/A
- Chairperson table
- Lectern

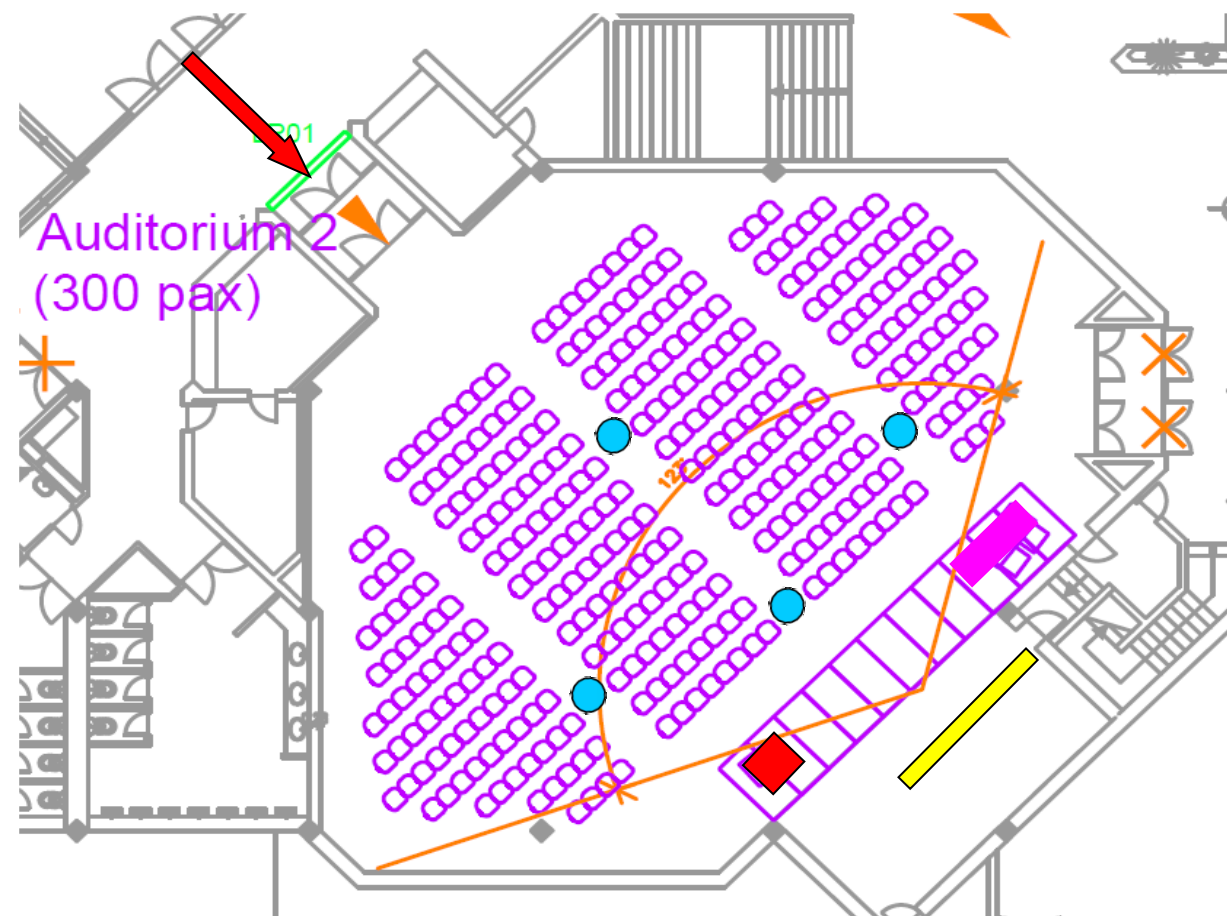

CONGRESS NAME	ICNC 2019, Lisboa	
Room Name	Porto - LR2 - Room 5B+C	
Capacity	250 seats arranged in theatre style	
Stage Size	W: 300 / D: 200 / H: 20 cm (Chair) & W: 200 / D: 200 / H:20cm(Lect)	
For Chairpersons	Table Dimensions	4x (W x D x H : 80 x 60 x 71cm)
	Standard setup	2 Tables + 4 chairs
	Microphones	2 wired Goose Neck
	Video Monitor	40" on chairperson table x 1
	Camera	NO
For Speaker	Lectern Dimensions	W: 66 / D: 60 / H: 110 cm
	Microphones	2 Wired Goose Neck
	Computer	1 classic laptop Cym networked with SSC
	Camera	NO
Main Screen	280 x 160	
Projector	8K - 1920*1080	
PinP	NO	
Voting / Ask a question system	NO	
Live sessions enabled	NO	
Audience	4 HAND HELD WIRELESS	
External monitor for room programme and overflow	NO	

Lecture Room plan

- Screen
- Room entrance(s)
- Microphone Q/A
- Chairperson table
- Lectern

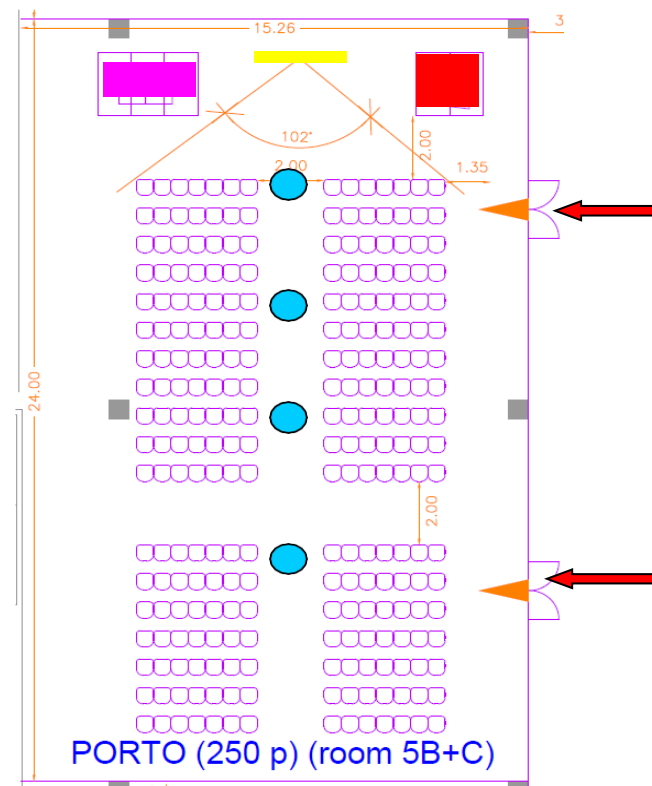

CONGRESS NAME	ICNC 2019, Lisboa	
Room Name	Faro - LR3 - Room 5A	
Capacity	150 seats arranged in theatre style	
Stage Size	W: 300 / D: 200 / H: 20 cm (Chair) & W: 200 / D: 200 / H:20cm(Lect)	
For Chairpersons	Table Dimensions	4x (W x D x H : 80 x 60 x 71cm)
	Standard setup	2 Tables + 4 chairs
	Microphones	2 wired Goose Neck
	Video Monitor	32" on chairperson table x 1
	Camera	NO
For Speaker	Lectern Dimensions	W: 66 / D: 60 / H: 110 cm
	Microphones	2 Wired Goose Neck
	Computer	1 classic laptop Cyim networked with SSC
	Camera	NO
Main Screen	280 x 160	
Projector	6K - 1920 X 1080	
PinP	NO	
Voting / Ask a question system	NO	
Live sessions enabled	NO	
Audience	2 HAND HELD WIRELESS	
External monitor for room programme and overflow	NO	

Lecture Room plan

- Screen
- Room entrance(s)
- Microphone Q/A
- Chairperson table
- Lectern

