

| | | |
|---|-------------------------------------|--|
| CONGRESS NAME | EuroPrevent 2019, Lisbon | |
| Room Name | Lisboa - LR1 - Auditorium 2 | |
| Capacity | 300 seats arranged in theatre style | |
| Stage Size | W: 1100 / D: 200 / H: 20 cm | |
| For Chairpersons | Table Dimensions | 4x (W x D x H : 80 x 60 x 71cm) |
| | Standard setup | 2 Tables + 4 chairs |
| | Microphones | 2 wired Goose Neck |
| | Video Monitor | 40" on chairperson table x 1 |
| | Camera | NO |
| For Speaker | Lectern Dimensions | W: 66 / D: 60 / H: 110 cm |
| | Microphones | 2 Wired Goose Neck |
| | Computer | 1 classic laptop Cyim networked with SSC |
| | Camera | NO |
| Main Screen | 508 x 294 | |
| Projector | 12K - 1920*1080 | |
| PinP | NO | |
| Voting / Ask a question system | NO | |
| Live sessions enabled | NO | |
| Audience | 4 HAND HELD WIRELESS | |
| External monitor for room programme and overflow | NO | |

Lecture Room plan

- Screen
- Room entrance(s)
- Microphone Q/A
- Chairperson table
- Lectern

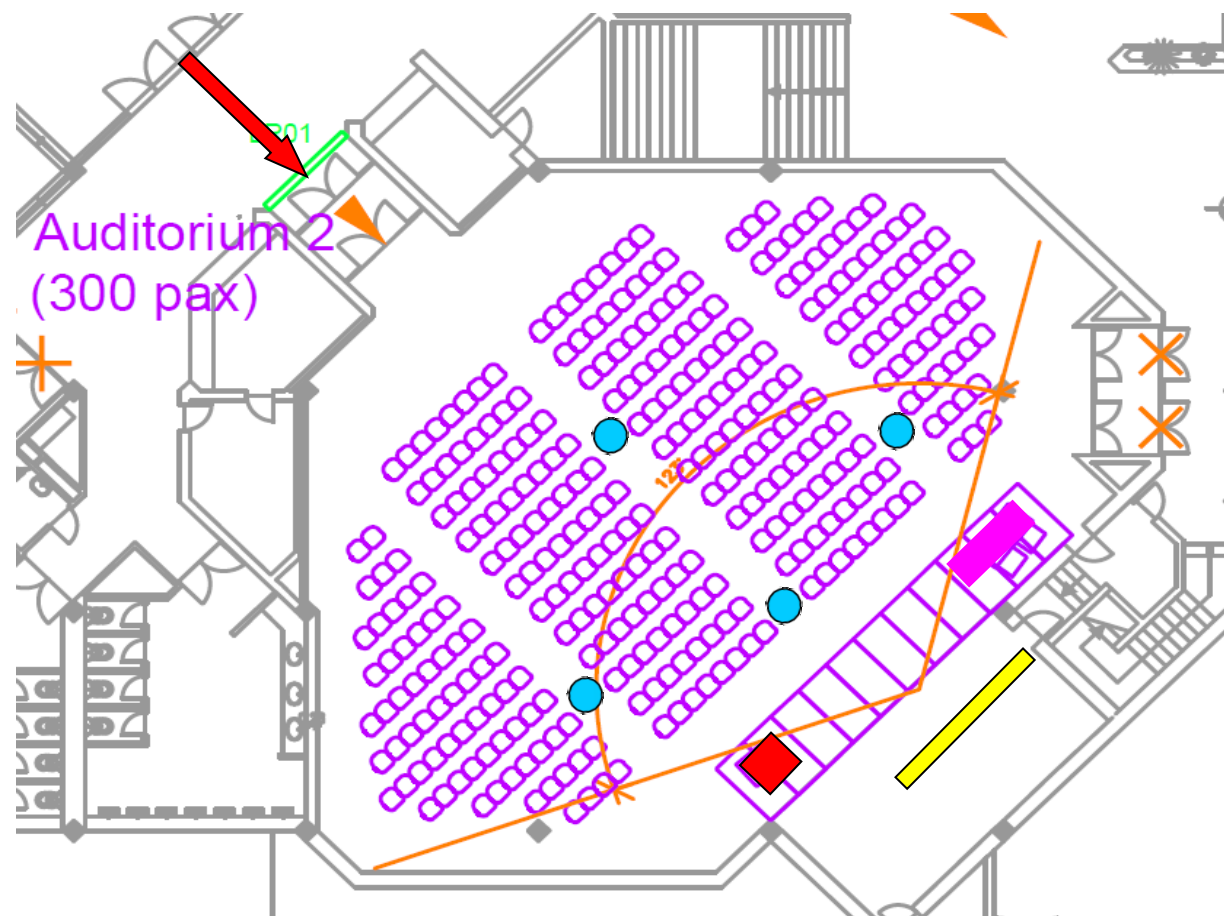

| | | |
|---|---|---|
| CONGRESS NAME | EuroPrevent 2019, Lisbon | |
| Room Name | Porto - LR2 - Room 5B+C | |
| Capacity | 250 seats arranged in theatre style | |
| Stage Size | W: 300 / D: 200 / H: 20 cm (Chair) & W: 200 / D: 200 / H:20cm(Lect) | |
| For Chairpersons | Table Dimensions | 4x (W x D x H : 80 x 60 x 71cm) |
| | Standard setup | 2 Tables + 4 chairs |
| | Microphones | 2 wired Goose Neck |
| | Video Monitor | 40" on chairperson table x 1 |
| | Camera | NO |
| For Speaker | Lectern Dimensions | W: 66 / D: 60 / H: 110 cm |
| | Microphones | 2 Wired Goose Neck |
| | Computer | 1 classic laptop Cym networked with SSC |
| | Camera | NO |
| Main Screen | 280 x 160 | |
| Projector | 8K - 1920*1080 | |
| PinP | NO | |
| Voting / Ask a question system | NO | |
| Live sessions enabled | NO | |
| Audience | 4 HAND HELD WIRELESS | |
| External monitor for room programme and overflow | NO | |

Lecture Room plan

- Screen
- Room entrance(s)
- Microphone Q/A
- Chairperson table
- Lectern

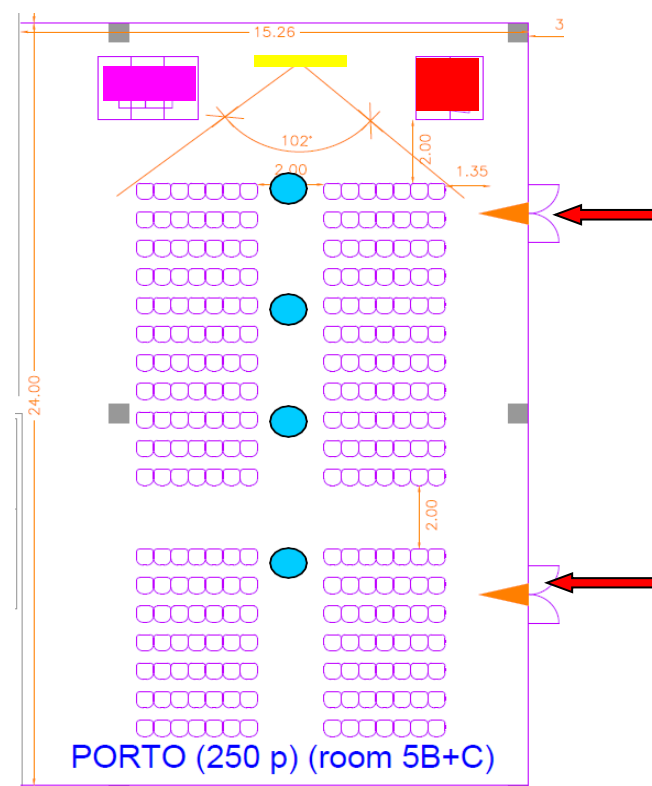

| | | |
|---|-------------------------------------|--|
| CONGRESS NAME | EuroPrevent 2019, Lisbon | |
| Room Name | Faro - LR3 - Auditorium 3+4 | |
| Capacity | 180 seats arranged in theatre style | |
| Stage Size | W: 600 / D: 200 / H: 40 cm | |
| For Chairpersons | Table Dimensions | 4x (W x D x H : 80 x 60 x 71cm) |
| | Standard setup | 2 Tables + 4 chairs |
| | Microphones | 2 wired Goose Neck |
| | Video Monitor | 40" on chairperson table x 1 |
| | Camera | NO |
| For Speaker | Lectern Dimensions | W: 66 / D: 60 / H: 110 cm |
| | Microphones | 2 Wired Goose Neck |
| | Computer | 1 classic laptop Cyim networked with SSC |
| | Camera | NO |
| Main Screen | 345 x 203 | |
| Projector | 8K - 1920 x 1080 | |
| PinP | NO | |
| Voting / Ask a question system | NO | |
| Live sessions enabled | NO | |
| Audience | 4 HAND HELD WIRELESS | |
| External monitor for room programme and overflow | NO | |

Lecture Room plan

- Screen
- Room entrance(s)
- Microphone Q/A
- Chairperson table
- Lectern

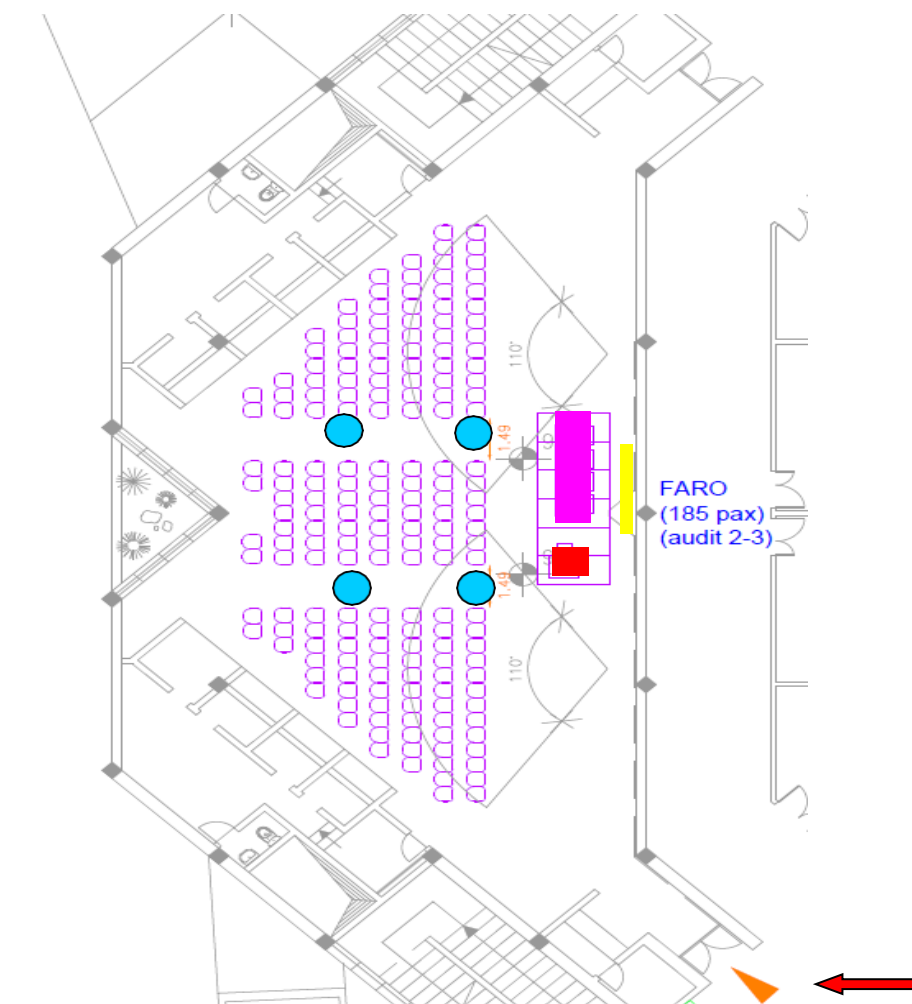

| | | |
|---|---|--|
| CONGRESS NAME | EuroPrevent 2019, Lisbon | |
| Room Name | Coimbra - LR4 - Room 5A | |
| Capacity | 150 seats arranged in theatre style | |
| Stage Size | W: 300 / D: 200 / H: 20 cm (Chair) & W: 200 / D: 200 / H:20cm(Lect) | |
| For Chairpersons | Table Dimensions | 4x (W x D x H : 80 x 60 x 71cm) |
| | Standard setup | 2 Tables + 4 chairs |
| | Microphones | 2 wired Goose Neck |
| | Video Monitor | 32" on chairperson table x 1 |
| | Camera | NO |
| For Speaker | Lectern Dimensions | W: 66 / D: 60 / H: 110 cm |
| | Microphones | 2 Wired Goose Neck |
| | Computer | 1 classic laptop Cyim networked with SSC |
| | Camera | NO |
| Main Screen | 280 x 160 | |
| Projector | 7K - 1920 X 1080 | |
| PinP | NO | |
| Voting / Ask a question system | NO | |
| Live sessions enabled | NO | |
| Audience | 3 HAND HELD WIRELESS | |
| External monitor for room programme and overflow | NO | |

Lecture Room plan

- Screen
- Room entrance(s)
- Microphone Q/A
- Chairperson table
- Lectern

