

ESC CONGRESS

ROME 2016

27 – 31 August



Exhibition Lounges

Where the world of cardiology comes together

www.escardio.org/ESC2016





General Conditions and Description

The ESC will build standard sound-reduced rooms of 50m² within the congress centre. Each room has a surface of 6x8.5m. (50m² internal space). **These state of the art rooms are located in the exhibition halls.**

PRODUCT SPECIFICATION:

- Exhibition Lounges will include standard electricity supply (4 sockets -1 per wall- 1KW each and general control box), air-conditioning (2 air conditioner 12000 Btu separately adjustable), daily cleaning and double sliding doors locked with a coded key pad (codes will be provided before congress start). The floor is on a raised platform 12cm covered in standard grey carpet accessible by an inclined ramp covered with the same carpet.
- Furniture (no desk and table allowed outside rooms), AV and customisation need to be ordered from **StudioArancio**, ESC official suppliers and are billable as extras. External walls can not be altered or modified without a written consent to be requested by email at congress@studioarancio.net attaching a specific request.
- Catering must be ordered from **Fiera Roma Catering**, ESC official caterer and is billable as extras.



Exhibition Lounges locations 1/2





Exhibition Lounge Assignment – Exhibition 1

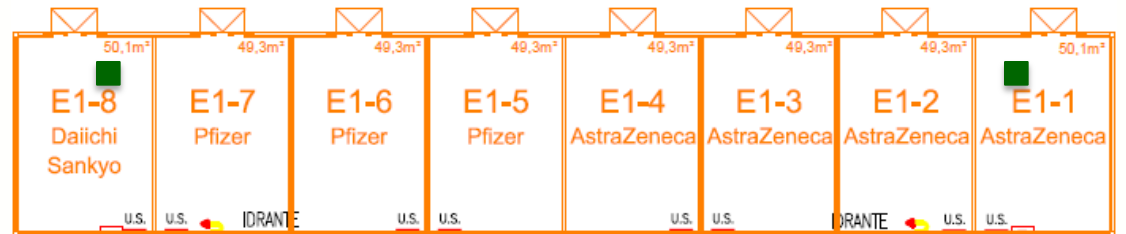
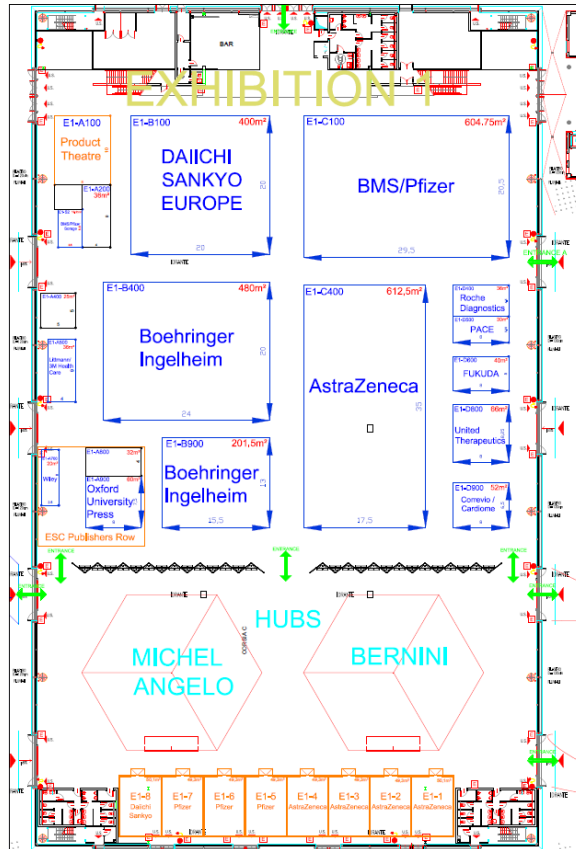

Column on the left

Column on the right

■ Dimension of the column with cladding 40cm x 50cm



Exhibition Lounge Assignment – Exhibition 2

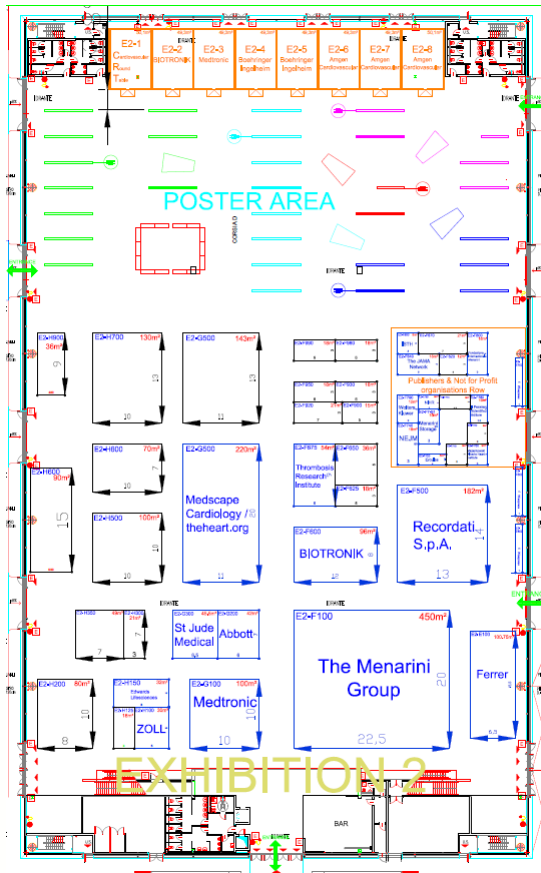

Column on the right

Column on the left

■ Dimension of the column with cladding 40cm x 50cm



Exhibition Lounge Assignment – Exhibition 3

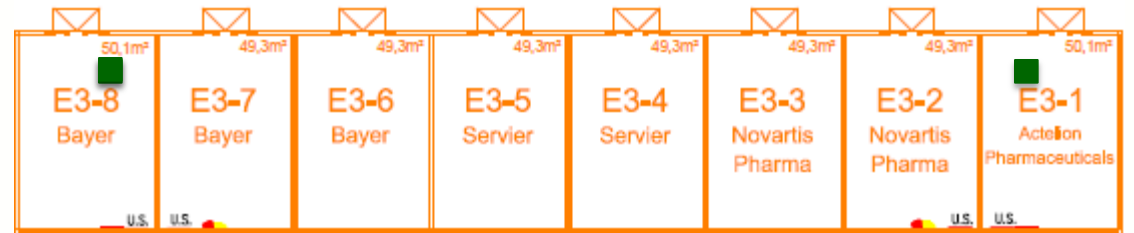
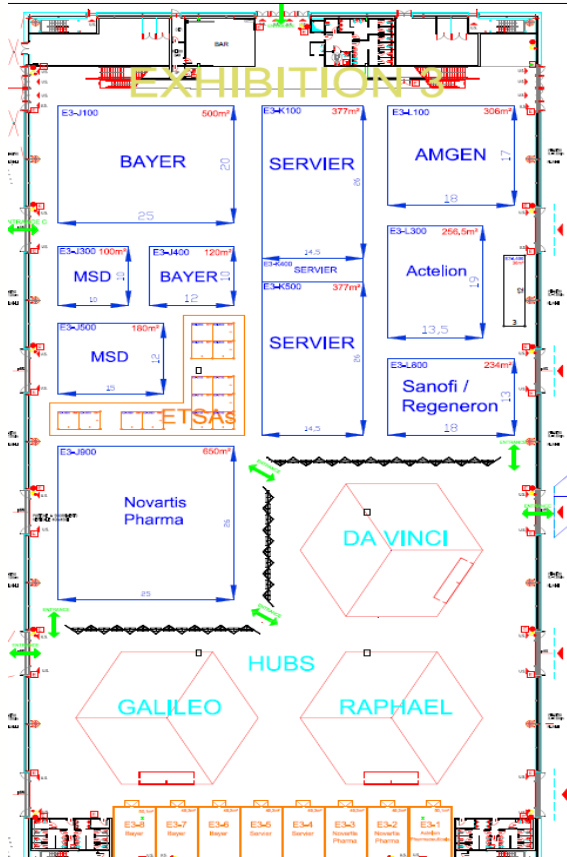

Column on the left

Column on the right

 Dimension of the column with cladding 40cm x 50cm



Exhibition Lounge Assignment – Exhibition 4

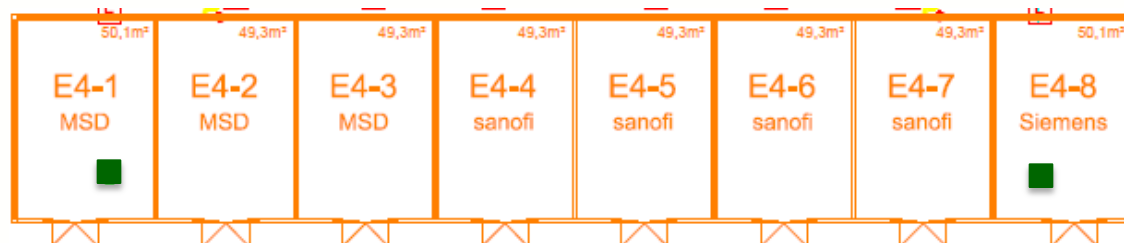

Column on the right

Column on the left

■ Dimension of the column with cladding 40cm x 50cm



Exhibition Lounge Auxiliary Services Catalog

We are pleased to present and share with you our full catalog to setting up your Exhibition Lounge(s).

Transform your Exhibition Lounge(s) into the main place for your Industry meetings with high quality furniture, Audio Video Equipment and Customisation items as floors covering and many others.

Please discover the catalog and the order form on our website: www.essexhibition.org/ESCCongress2016.

Note that the entire invoice amount is due by **June 15, 2016** and no order will be possible after **July 30, 2016**.

For any queries on these services, please contact our ESC official supplier **StudioArancio** at congress@studioarancio.net

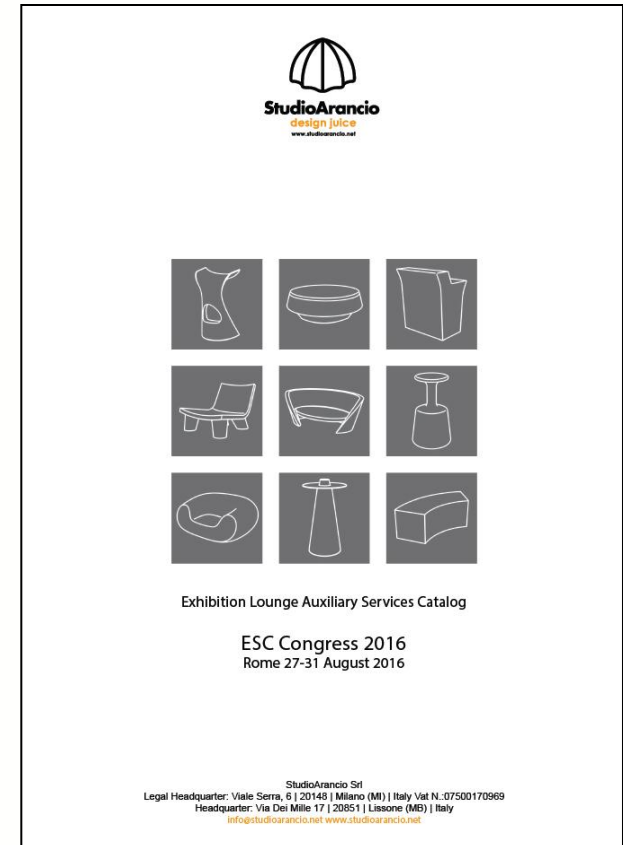



Exhibition Lounges Internet Solutions

To ensure the provision of a safe and effective Internet service for you, we have deployed in collaboration with our official supplier specific technical resources to ensure a quality service.

LÉNI EURODOC

.....

Contact

Meg BUISSON
☎ : +33 4 93 00 10 07
@ : mbuisson@eurodocument.com

Jean-Michel BOUTAUD
☎ : +33 6 12 11 15 00
@ : boutaud@eurodocument.com

.....

✉
108 Chemin Sainte Hélène
SOPHIA ANTIPOLIS
06560 VALBONNE
FRANCE

☎ : +33 (0)4 93 00 80 00
☎ : +33 (0)4 93 00 80 01

If you need help, do not hesitate to contact us by mail : mbuisson@eurodocument.com

3 different offers can be contracted to provide your Exhibition Lounge with Internet:

-Each room are pre-equipped with a network cable. You just have to order your Broadband Internet to make it work!

-ESC Congress general Wi-fi is available, but you can also order your own private Wi-fi network with a decent and guaranteed bandwidth Internet access.

- Should you decide to deploy your own Wi-fi service, a fixed charge per access point will be payable to our official supplier who will check the conformity of your equipment and ensure no interference with the overall Wifi service at ESC Congress 2016.

To connect all your devices, please proceed to your order directly on our official supplier website: Eurodoc by Leny

Deadline to place your order: 22 July 2016

Failure to report Wi-Fi equipment could lead to an immediate requirement to suspend equipment onsite.



Exhibition Lounge Signage/Branding

- The ESC will take care of the generic signage within the congress centre.
- No other signage or promotion can be made within the building.
Additional signs, posters or roll-up placed in front of the room or anywhere else in the convention centre are not allowed and will be removed.
- 1 standard room branding on the facade of the room is included in the Exhibition Lounge rental: **1 panel landscape format (200cm x 100cm)**
Room branding must receive prior approval from the ESC (company name, corporate logo & visual only). **Deadline: 30 June 2016**
- The room number will be indicated on the top of room entrance doors.



Specifications are as follow: **FORMAT AND RESOLUTION:**

RASTERIZED FILES: scale 1:1 (Final dimension) - method CMYK - final resolution at least 100dpi

alternatively file with proportional dimensions (example: dim. 100x200cm. final 100dpi, dim. 25x50cm. file at 400dpi)

CHARACTERS: Converts to paths or attach font folder

ACCEPTED FORMATS: Ai, Eps, Jpg, Tiff, Pdf, Psd

ADHESIVE LOGO: vector format

N.B: In case of logos without shading, the logo will be stick on the lacquered panel.



Exhibition Lounge Catering

- Catering services within the Exhibition Lounges, can be organised with the **Fiera Roma Catering**, ESC official caterer, at the sponsor's cost.

For orders and estimates please contact Fiera Roma Catering

Enzo Giulio Tognetti: eg.tognetti@fieraroma.it +39 06 65074 240

Massimiliano Sufferini: m.sufferini@fieraroma.it +39 06 65074 241

Fax: +39 06 65074 462

General : catering@fieraroma.it

- Companies will have the right to serve **alcoholic beverages** at the following dates and times only:

Dates	Times
Saturday 27 August 2016	after 18:00
Sunday 28 August 2016	after 20:00
Monday 29 August 2016	after 20:00
Tuesday 30 August 2016	after 19:15



Exhibition Lounge Access Schedule

Friday 26 August 2016

08:00-23:00 Access for exhibitors - Room set-up and decoration allowed
Access for delegates not allowed

Saturday 27 August 2016

07:00-20:00 Access for exhibitors
07:00-20:00 Access for delegates via Registration, ESC Plaza, Lecture Room Villages, The Hub and Poster Area
12:30-18:00 Access for delegates via the Exhibition

Sunday 28 August, Monday 29 August 2016

07:00-20:00 Access for exhibitors
07:00-20:00 Access for delegates via Registration, ESC Plaza, Lecture Room Villages, The Hub and Poster Area
09:00-18:00 Access for delegates via the Exhibition

Tuesday 30 August 2016

07:00-24:00 Access for exhibitors
07:00-20:00 Access for delegates via Registration, ESC Plaza, Lecture Room Villages, The Hub and Poster Area
09:00-18:00 Access for delegates via the Exhibition
20:00-24:00 Removal of Exhibition Lounge valuables

Wednesday 31 August 2016

Exhibition Lounges no longer available

ESC CONGRESS

ROME 2016

27 – 31 August



Where the world of cardiology comes together

Thank you!

The ESC wishes you a very successful
ESC congress 2016 in Roma

#esccongress

www.escardio.org/ESC2016

