

# COLUMNS DETAILS

## Gran Via

Hall 1	C101 to C105	page 3
Hall 2	C201 to C205	page 9
Hall 3	C301 to C305	page 19
Hall 4	C401 to C405	page 24
Hall 5	C501 to C505	page 28
Hall 6	C601 to C605	page 34
Hall 7	C701 to C705	page 39
Underwalkway	CU01 to CU04	page 45
Hall 8.0	C8001 to C8005	page 50
Hall 8.1	C8101 to C8105	page 56

# INSTRUCTIONS

Please check the floorplans to locate each column type name.

Columns are named as

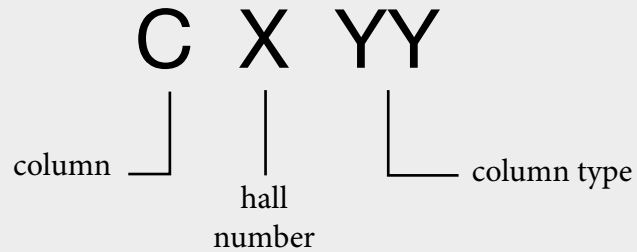

## Technical constraints

No construction elements can be supported by or onto walls, columns or other fixed elements of the halls, and adequate protection must be used or a safe distance must be maintained between the construction materials and the hall walls. In no case should the stability of any object, assembly or structure be conditioned to the infrastructure of Fira de Barcelona. All elements must be self-supporting and self-standing.

Hall columns inside the stand can be cladded without damaging them and in accordance with the permitted height regulations, taking into account the fact that, in the case of connection boxes, these boxes can always be registered. Vinyl columns can only be installed by official Fira suppliers. This service can be contracted through the sales department of Fira Barcelona ([www.servifira.com](http://www.servifira.com))

In the case of cladding or decorating columns with fire equipment, extinguishers, fire alarm call points, signage or any other informational element of the venue, they must always be visible and accessible. They cannot be manipulated nor broken down.

## Cladding policy

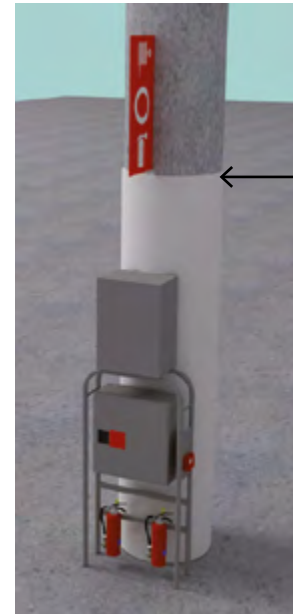

A vinyl can reach up to the upper fire signage



The cladding cannot cover the upper signage

Some of the fire equipment in Halls 3, 4 and 6 include fixed switchboards. These columns are marked with the letter *b* after the type name. The switchboards can be cladded but need to remain accessible during build up and dismantling to other exhibitors.

# HALL 3 Floorplan

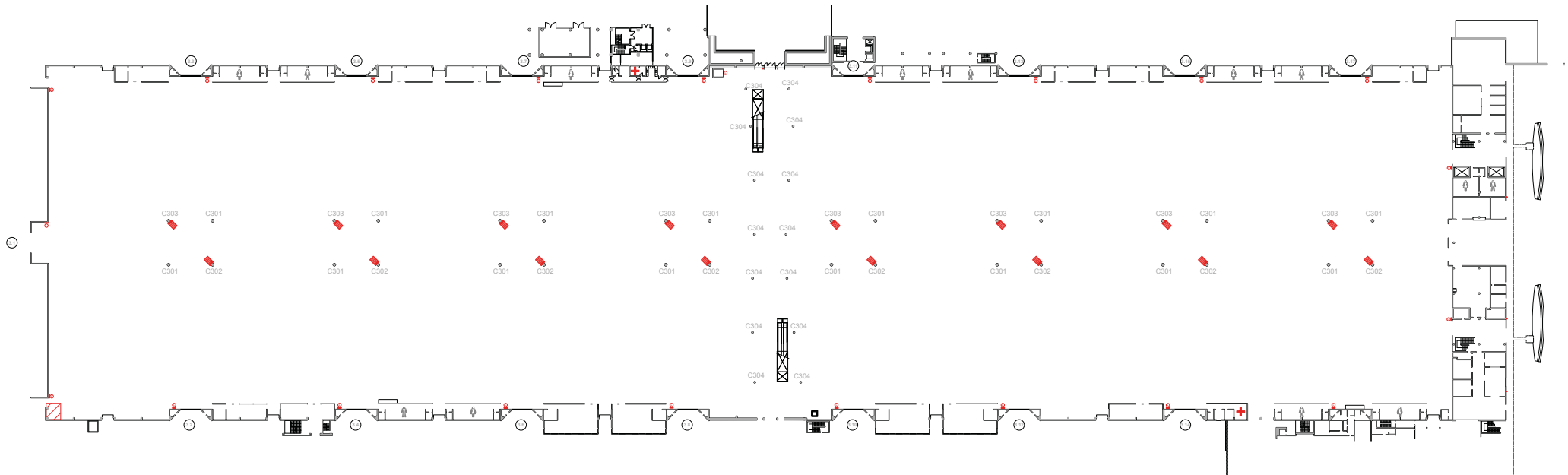

# Column details - Gran Via Hall 3

## Column type C301

### Floorplan & Dimensions

---

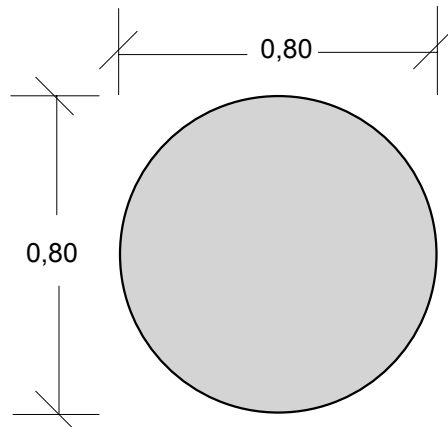

### Picture

---





# Column details - Gran Via Hall 3

## Column type C302

### Floorplan & Dimensions

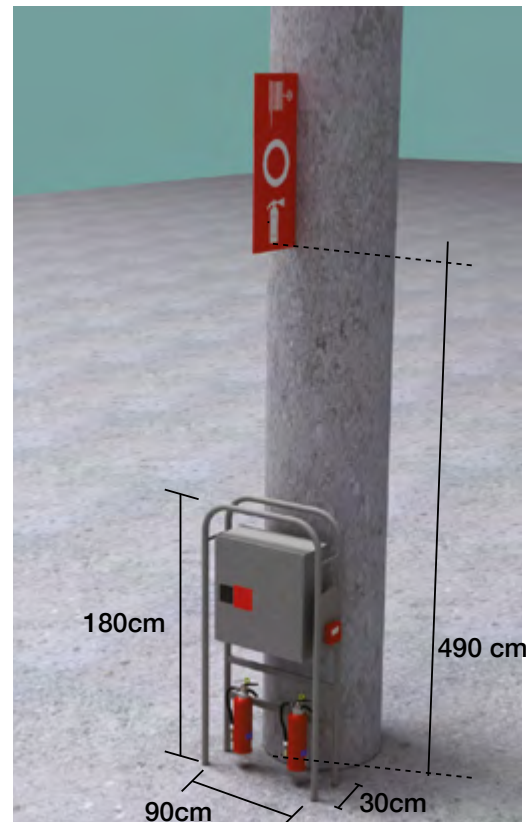
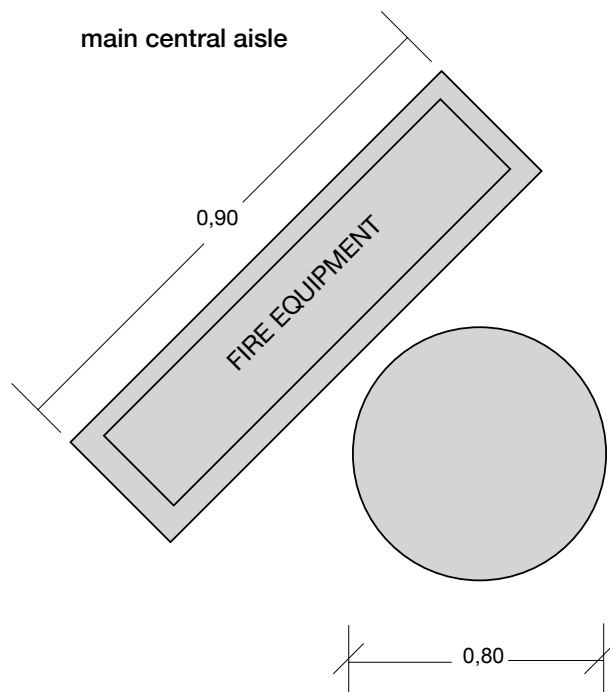

Note that the fire extinguisher equipment and sign need to remain accessible and visible at all times.

### Picture

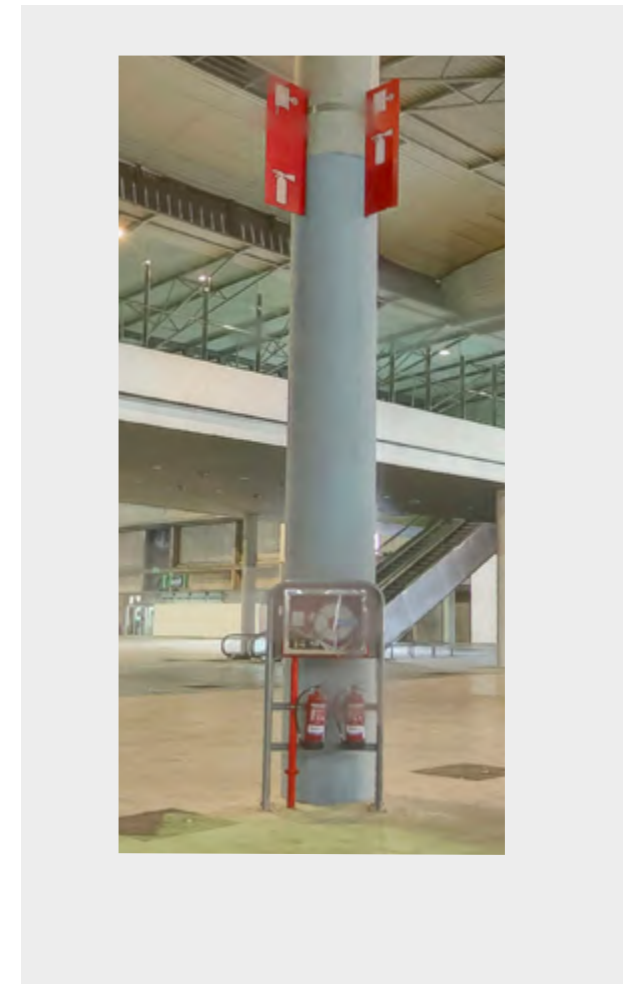

# Column details - Gran Via Hall 3

## Column type C303

### Floorplan & Dimensions

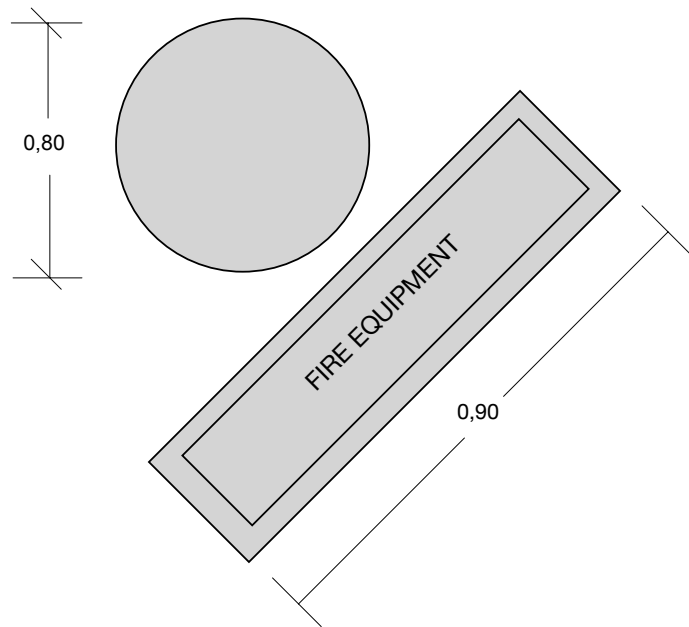

main central aisle

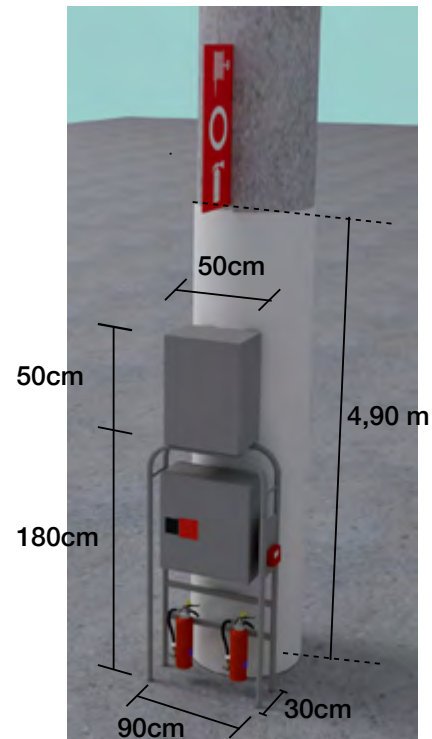

Note that the fire extinguisher equipment and sign need to remain accessible and visible at all times. These columns include a switchboard with 12 schuko type sockets of 10A to be used during build-up only.

### Picture

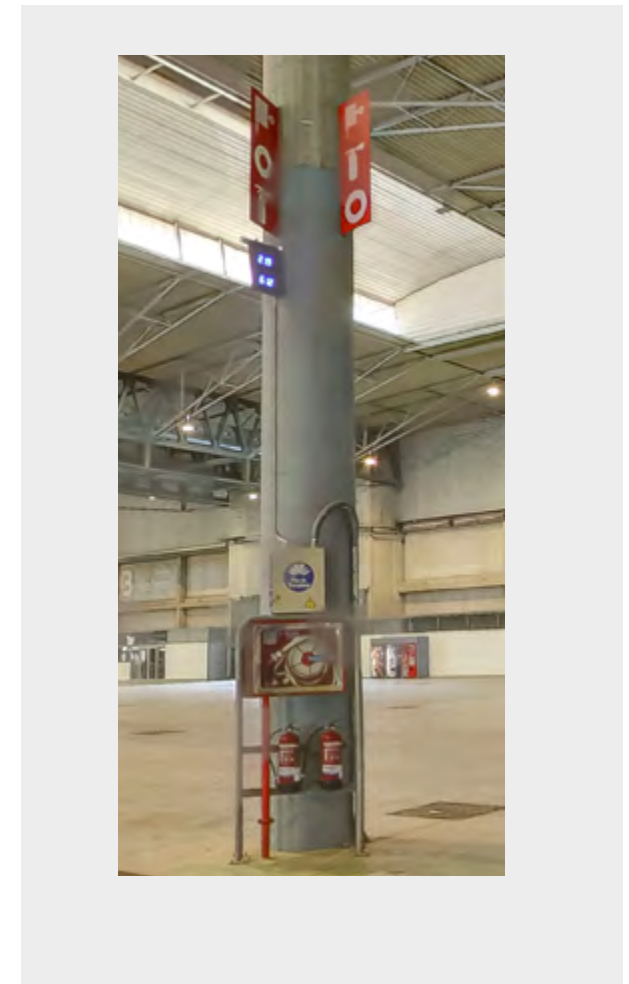

# Column details - Gran Via Hall 3

## Column type C304

### Floorplan & Dimensions

---

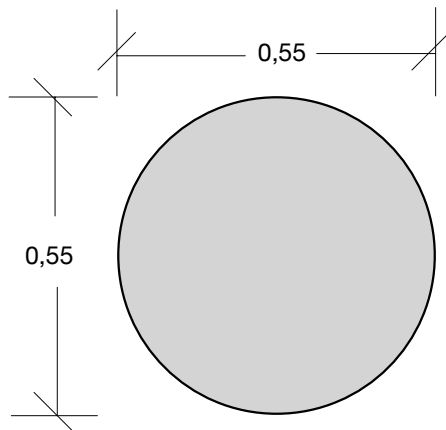

### Picture

---

