

OVERVIEW OF FUNCTION SPACE - ALLOCATION

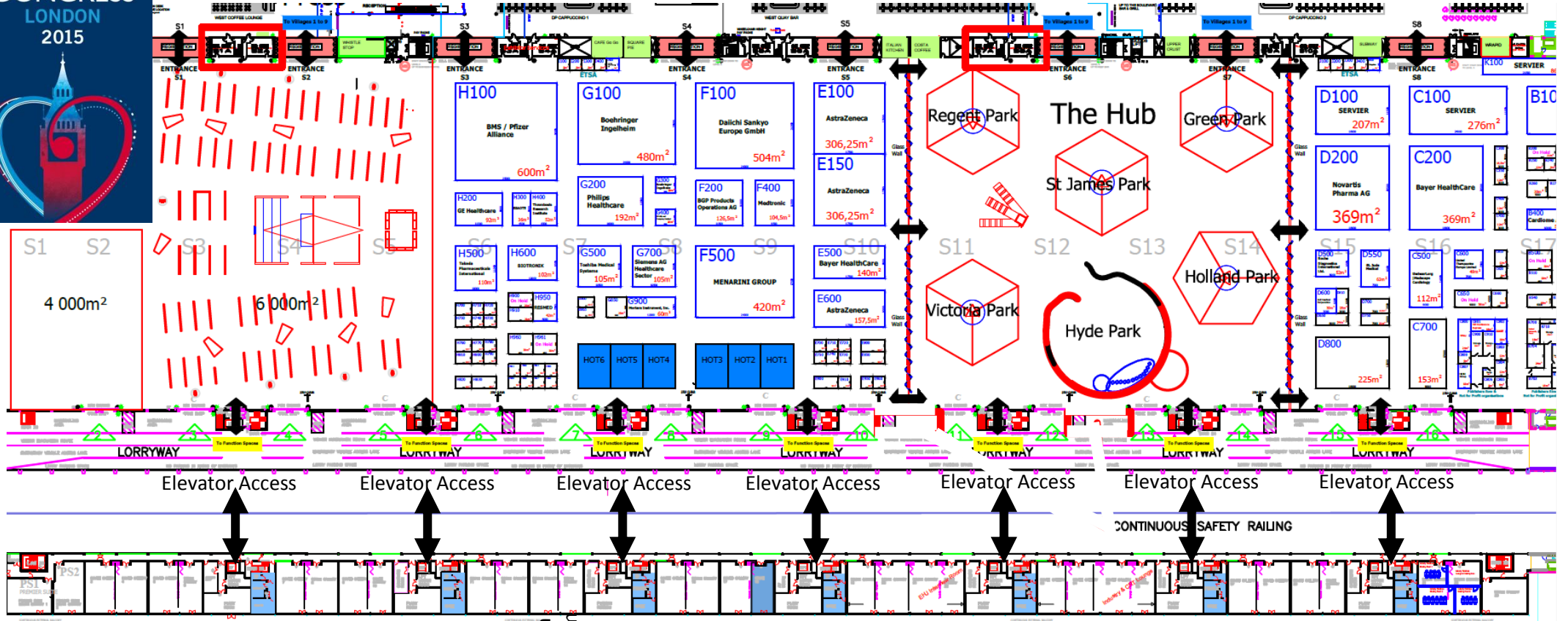



- Function Spaces South**
- Function Space 1 (96m²) BIOTRONIK
 - Function Space 2 (95m²) Neurovive
 - Function Space 3 (97m²) MEDTRONIC
 - Function Space 4 (97m²) Pfizer
 - Function Space 5 (97m²) Pfizer
 - Function Space 6 (71m²) BMS/Pfizer
 - Function Space 7 (97m²) Siemens
 - Function Space 8 (97m²) MSD
 - Function Space 9 (97m²) MSD
 - Function Space 10 (71m²) MSD
 - Function Space 11 (97m²) Bayer
 - Function Space 12 (97m²) Bayer
 - Function Space 13 (97m²) Boehringer Ingelheim
 - Function Space 14 (71m²) Boehringer Ingelheim
 - Function Space 15 (97m²) Astra Zeneca
 - Function Space 16 (97m²) Astra Zeneca
 - Function Space 17 (97m²) Astra Zeneca
 - Function Space 19 (97m²) AstraZeneca
 - Function Space 20 (97m²) Actelion
 - Industry Relations Offices (Room 21/22)
 - Function Space 23 (97m²) Novartis
 - Function Space 24 (97m²) Sanofi
 - Industry & CRT lounge
 - Function Space 27 (97m²) Sanofi
 - Function Space 28 (97m²) Sanofi
 - Function Space 29 (97m²) Sanofi
 - Function Space 30 (71m²) Sanofi
 - European Heart Journal
 - Function Space 33 (96m²) Servier

NOTE: The South Gallery on this overview corresponds to its exact location with regard to the building overview.

To see more details of your stand space, please find the [exhibition floor plan here](#). The access points will lead from the function spaces to the Poster area, Exhibition, and Hub are symbolised by an arrow.

Overview information:

Elevator Access 

Access to poster, Exhibition, & the Hub 

Function Space contact: Ms. Samantha Bickham roomservices@escardio.org
Dedicated industry website: http://www.escehhibition.org/ESC2015/partner_services/

Function space set up + signage: Ms. Helen Stanley helenstanley@excel-london.co.uk

Catering contacts: **Deadline 3 August** LeithsExCeL@compass-group.co.uk or +44(0)20 7069 4100

Catering: http://www.escehhibition.org/ESC2015/partner_services/ESC%20Items/Function-spaces_Industry-Meeting-Rooms-Catering-Offer-ESC.pdf

Alternate furniture contact: **Deadline 10 August** and contact congress2@ges.com or phone: +44 2476 380 180

Catalogue available on our website http://www.escehhibition.org/ESC2015/partner_services/

Contact: **Deadline 10 August** and contact gparker@blitzcommunications.co.uk

Av/equipment: http://www.escehhibition.org/ESC2015/partner_services/ *information will be available on the website at a later stage*